

READ THESE IMPORTANT OPERATING  
INSTRUCTIONS BEFORE USING YOUR

# MINIATURE

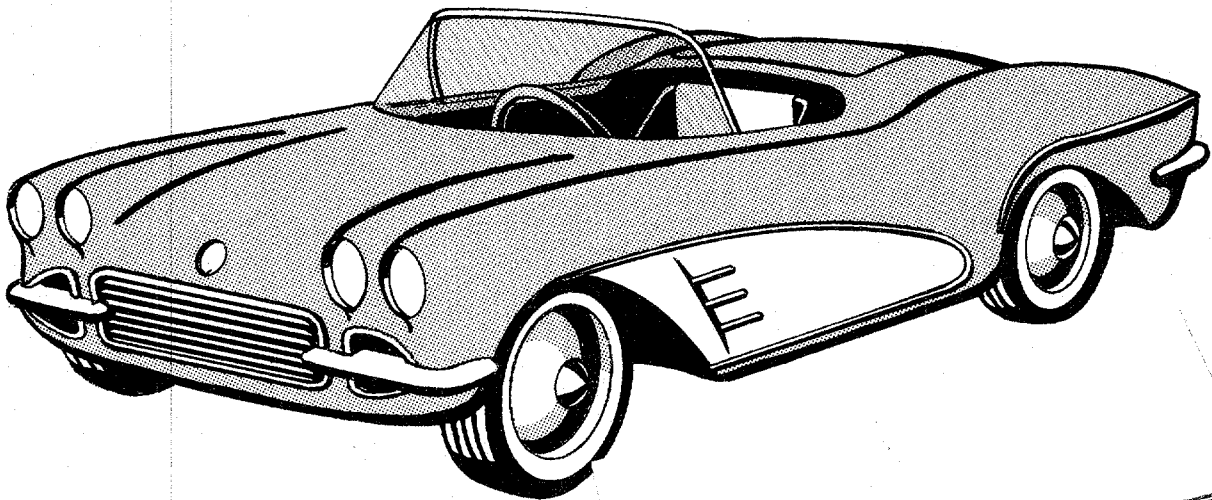

# CORVETTE

**YARD-MAN** Incorporated

1410 W. GANSON ST., JACKSON, MICHIGAN.

## INTRODUCTION

Here is a car designed for off-street use such as backyards, parking lots and other supervised areas. In order to stress the importance of safe driving we have provided the booklet "What Every Young Student Driver Must Know."

These rules and regulations apply to operators of licensed motor vehicles and must be taught the young driver now and made applicable to the operation of his driveway car in off-street driving.

If the fundamentals of safe driving are instilled in the minds of future automobile drivers, it will be an important step forward in making our highways "safeways" instead of "speedways."

INSTALLATION OF THE WINDSHIELD IS THE ONLY ASSEMBLY WORK REQUIRED FOR YOUR CAR. PARTS FOR INSTALLING WINDSHIELD ARE INCLUDED IN SMALL PARTS PACKAGE. FOLLOW THESE INSTRUCTIONS BEFORE OPERATING. FOR COMPLETE ENGINE INFORMATION SEE ENGINE OPERATING MANUAL FURNISHED WITH YOUR CAR. ALSO REFER TO ENGINE WARRANTY STIPULATIONS COVERED IN THE ENGINE MANUAL.

### TO INSTALL WINDSHIELD

1. Remove necessary parts from small parts package.
2. Slip flexible chrome trim over outside edge of windshield, (opposite mounting holes). Trim may be secured with a small amount of household glue at each end.
3. Attach mounting brackets to windshield (fig. 1) locating the two 70° brackets at the side mounting holes and the three 60° brackets at the remaining holes. Place flat washers under screw heads to reinforce windshield, tighten nuts finger tight.
4. Attach windshield to body cowl, placing flat washers next to underside of cowl for support, (fig. 1). Tighten nuts finger tight.
5. Starting at the center mounting bracket align windshield with front edge of cowl and tighten mounting nuts securely.
6. Repeat this procedure, working from center toward each side until all mounting brackets are securely tightened.

### BEFORE STARTING ENGINE

1. Lift deck lid and remove oil filler plug. Using a long funnel, fill to top of oil filler with one (1) pint S.A.E. 20 oil. Replace plug and tighten.
2. Fill fuel tank with good grade regular, clean gasoline. DO NOT MIX OIL with gasoline.

### OPERATING INSTRUCTIONS

1. Learn to use the foot control pedals before you drive your Corvette. The pedals are shown in Figure 2.
2. When you start to drive you should push the accelerator pedal (right pedal) slowly forward, picking up speed as you move. Pushing down too fast on the accelerator pedal may stall engine.
3. To bring your Corvette to a safe stop raise your foot from the accelerator pedal and press down on the brake pedal.

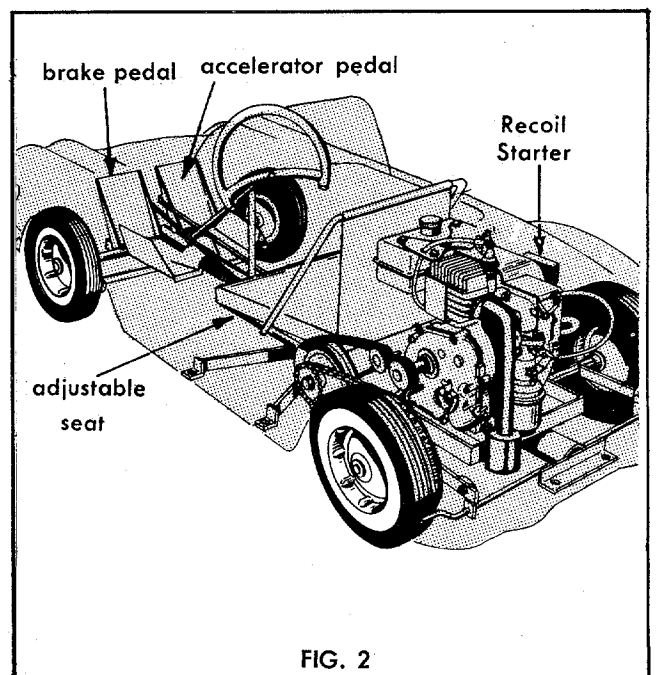
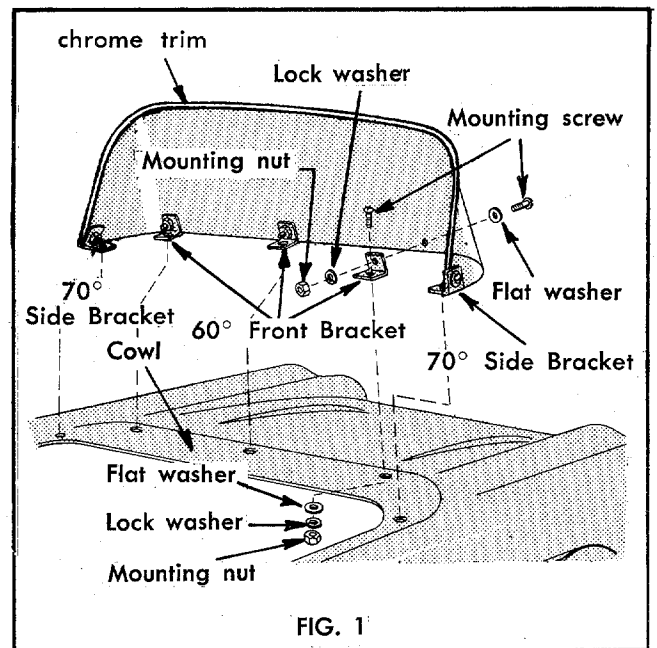

## STARTING ENGINE

1. Lift deck lid.
2. Push choke lever down.
3. Pull starter rope. Push choke lever up slowly as engine warms up. **LET ENGINE WARM UP SEVERAL MINUTES BEFORE YOU DRIVE.**

TO STOP ENGINE—Press button located at back of cockpit and hold until engine stops.

## BREAK IN PERIOD

1. During first 10 hours of driving check the following:
  - Check oil level in engine crankcase every 2 hours. After break in period check oil level every 4 or 5 hours.
  - Check chain and drive belt tension. (See Instructions for Chain and V-Belt Adjustments.)
  - Check all bolts, nuts and screws for tightness.
  - CAUTION—Avoid contact with hot muffler.

## SERVICE INSTRUCTIONS

ALWAYS REMOVE SPARK PLUG WIRE BEFORE MAKING ADJUSTMENTS — NEVER MAKE ANY ADJUSTMENTS WITH ENGINE RUNNING. Your Corvette left the factory properly adjusted and properly lubricated.

## SEAT ADJUSTMENT

1. The seat has been set in the back position.
2. To adjust drivers seat, loosen seat clamp bolts, move seat to comfortable drivers position and retighten nuts. **DO NOT OVERTIGHTEN NUTS**, otherwise the movement of the swivel type frame will be restricted or even stopped.

## DRIVE ASSEMBLY ADJUSTMENT (Chain & V-Belt)

DO NOT MAKE ANY ADJUSTMENTS while engine is running or if engine is dangerously warm.

1. Enter cockpit of Corvette facing engine.
2. Loosen jackshaft retaining nut.
3. Slide jackshaft assembly toward front of car. While holding this tension retighten jackshaft retaining nut.
4. Chain should have approximately  $\frac{1}{8}$ " slack after adjustment is made. See Figure 5.
5. Lower belt guide must fit snugly against idler belt.

## TO REPLACE CHAIN

1. Loosen and slide jackshaft assembly to extreme rear position.
2. If chain is intact remove master link.
3. Replace with new chain and make necessary adjustments. See drive assembly adjustments.

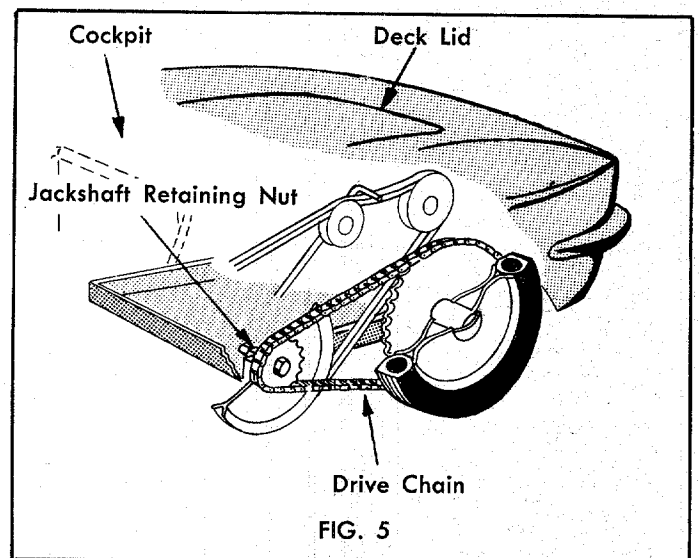
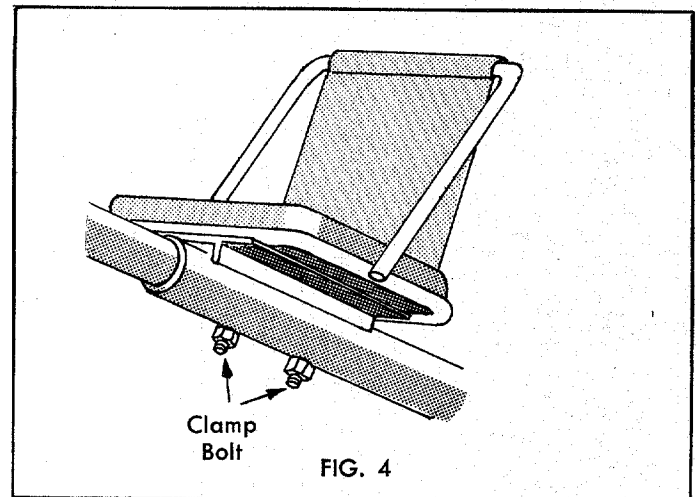
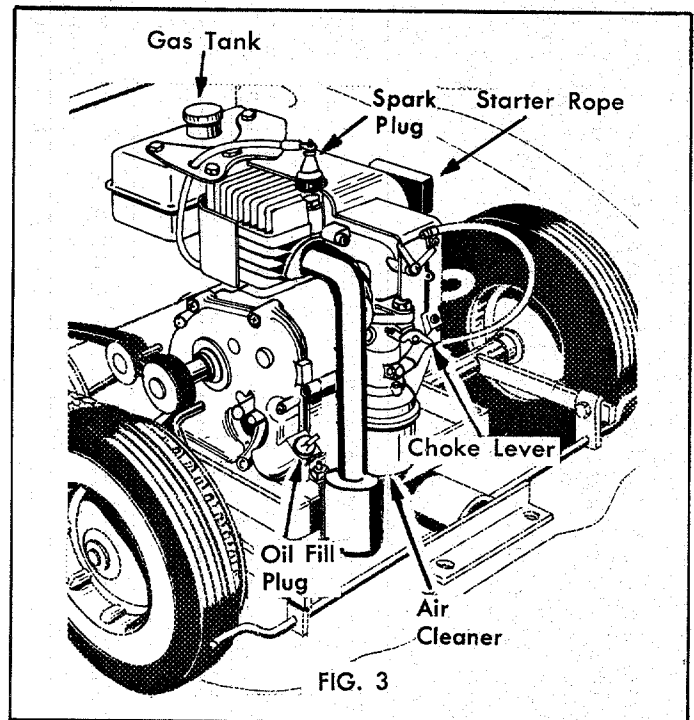

## CORVETTE MODEL 6032-2 DRIVEWAY CAR

ORDER ALL REPAIR PARTS FROM YARD-MAN INCORPORATED  
1410 W. GANSON ST., JACKSON, MICHIGAN.

WHEN ORDERING REPAIR PARTS, ALWAYS GIVE THE FOLLOWING INFORMATION AS SHOWN IN THIS LIST:

1. THE PART NUMBER.
2. THE PART NAME.
3. THE MODEL NUMBER.
4. THE NAME OF ITEM.

Do not use Key Numbers when ordering Repair Parts, always use Part Numbers.  
Your Unit is right hand (R.H.) or left hand (L.H.) as you stand behind it.

### PARTS LIST

Key No.	Part No.	Description	Key No.	Part No.	Description
1	4108-57-22	Wheel & Tire Ass'y. <i>NLA</i>	51	2638-27-13	Sprocket—Drive <i>NLA</i>
2	<del>1650-9</del>	Retaining Ring <i>710-0106</i>	52	<del>1538-8</del>	Nut (1/4-20 Hex "Gripco") <i>712-0167</i>
3	3132-31 <i>NLA</i>	Body Bracket Ass'y.—Side	53	<del>52</del>	*Nut (3/8-24 Hex) <i>712-0291</i>
4	3181-2 <i>NLA</i>	Brake Rod & Bracket Ass'y.	54	1534-17 <i>NLA</i>	*Nut (3/8-16 Hex)
5	3-88 <i>NLA</i>	*Cotter Pin	55	877 <i>NLA</i>	Nut (3/8-24 Hex "Gripco")
6	4108-55-22	Wheel & Tire Ass'y.—Drive <i>NLA</i>	56	1538-5 <i>NLA</i>	Nut (3/8-24 Hex "Gripco")
7	5168-20 <i>NLA</i>	Frame Ass'y.—Rear	57	<del>0738-000</del>	Washer
8	2659-4 <i>NLA</i>	Bracket	58	1509-23 <i>NLA</i>	*Bolt (3/8-24 x 1/8 Hex Head)
9	5168-19 <i>NLA</i>	Frame Ass'y.—Front	59	<del>1540-57</del>	Washer <i>736-0300</i>
10	2119-23 <i>NLA</i>	Steering Shaft & Bracket Ass'y	60	<del>1076</del>	*Lockwasher <i>736-0167</i>
11	2683-18 <i>NLA</i>	Tie Rod	61	<del>1540-61</del>	*Washer—Flat <i>736-0142</i>
12	2181-5 <i>NLA</i>	Ass'y.—Ball Joint	62	1059 <i>NLA</i>	*Screw
13	3683-21 <i>NLA</i>	Rod—Accelerator Actuating	63	<del>1540-26</del>	*Washer <i>736-0192</i>
14	1642-22 <i>NLA</i>	Spring	64	1503-1 <i>NLA</i>	*Screw (#8-32 x 3/8 Fillister Head)
15	1549-16 <i>NLA</i>	Stud	65	169 <i>NLA</i>	*Bolt (3/8-18 x 2 1/2 Hex Head)
16	4663-7 <i>NLA</i>	Control Pedal	66	1508-13 <i>NLA</i>	Set Screw (3/8-24 x 1/2)
17	2167-7 <i>NLA</i>	Steering Spindle—R. H.	67	1020 <i>NLA</i>	*Screw #6 Drive Head)
18	2167-6 <i>NLA</i>	Steering Spindle—L. H.	68	2200-23-13	Engine <i>NLA</i>
19	1545-17 <i>NLA</i>	Clevis Pin	69	1538-13 <i>NLA</i>	Locknut (3/8-16 Hex Jam)
20	2624-80 <i>NLA</i>	Spacer	70	3609-137 <i>NLA</i>	Body Mounting Bracket—Center
21	2683-19 <i>NLA</i>	Rod—Pivot	71	<del>67</del>	*Nut (1/4-20 Hex) <i>712-0324</i>
22	2722-3 <i>NLA</i>	Axle—Rear	72	1540-30 <i>NLA</i>	Washer
23	4606-43 <i>NLA</i>	Engine Mounting Plate	73	1716-11 <i>NLA</i>	Ground Wire
24	1605-196 <i>NLA</i>	Name Plate	74	1540-2 <i>NLA</i>	*Washer
25	2659-6 <i>NLA</i>	Belt Guide—Lower	75	2624-79 <i>NLA</i>	Spacer
26	1132-34 <i>NLA</i>	Bracket Ass'y—Jackshaft Mtg.	76	1509-3 <i>NLA</i>	*Bolt (#10-32 x 1/4 Hex Head)
27	2132-24 <i>NLA</i>	Accelerator Bracket Ass'y	77	<del>1524-8</del>	Locknut (#10-32) <i>712-0102</i>
28	3683-20 <i>NLA</i>	Brake Actuator Rod	78	1537-2 <i>NLA</i>	Nut—"Acorn" (3/8-18 "Gripco")
29	1624-65 <i>NLA</i>	Sleeve	79	3132-40 <i>NLA</i>	Body Mount—front
30	3120-45-13	Jackshaft Ass'y <i>NLA</i>	80	3014-15 <i>NLA</i>	Body
31	3629-36 <i>NLA</i>	Retainer—Foot	81	1541-2 <i>NLA</i>	Lockwasher (3/8 Std. Split "Heavy")
32	5164-7-30	Seat <i>NLA</i>	82	4677-10 <i>NLA</i>	Windshield
33	3183-1-22	Steering Wheel <i>NLA</i>	83	2609-139 <i>NLA</i>	70° Side Bracket
34	1545-21 <i>NLA</i>	Clevis Pin	84	2609-140 <i>NLA</i>	60° Front Bracket
35	1547-12	Hair Pin Cotter	85	1501-16 <i>NLA</i>	*Screw (#10-32 x 1/2 Rd. Hd. Slotted)
36	4739-1 <i>NLA</i>	Seat Cushion	86	<del>1334-1</del>	Nut <i>712-0121</i>
37	3119-34 <i>NLA</i>	Idler Shaft Ass'y	87	1540-66 <i>NLA</i>	*Washer
38	2142-33 <i>NLA</i>	Bowden Wire	88	<del>1541-2</del>	Lockwasher <i>736-0722</i>
39	1120-48-13	Pulley <i>NLA</i>	89	1146-109 <i>NLA</i>	Assembly—Windshield
40	1626-40-13	Pulley <i>NLA</i>	90	4629-39 <i>NLA</i>	Retainer Extension—L.H.
41	2654-13 <i>NLA</i>	*Chain #65 American Standard	91	4629-40 <i>NLA</i>	Retainer Extension—R.H.
42	<del>2651-24</del>	V-Belt (32 1/2" Idler) <i>954-0935</i>	92	<del>136710-0192</del>	*Bolt (#10-32 x 3/8 Hex Head)
43	1674-15 <i>NLA</i>	Hub Cap	93	1509-79 <i>NLA</i>	*Bolt (3/8-24 x 3 Hex Head)
44	<del>1509-34</del>	*Bolt (1/4-20 x 3/4 Hex Head) <i>710-0252</i>	94	1085 <i>NLA</i>	*Cotter Pin
45	<del>1509-75</del>	*Bolt (1/4-20 x 1/2 Hex Head) <i>710-0289</i>	95	2717-7 <i>NLA</i>	Mounting Strap
46	1509-61 <i>NLA</i>	*Bolt (3/8-24 x 3/8 Hex Head)	96	932-00 <i>NLA</i>	Washer
47	<del>1509-70</del>	*Bolt (3/8-24 x 2 1/2 Hex Head) <i>710-0309</i>	97	<del>39-027</del>	*Lockwasher <i>736-0722</i>
48	1509-79 <i>NLA</i>	Bolt (3/8-24 x 3 Hex Head Special)	98	1160-8 <i>NLA</i>	Stop Switch
49	1529-17 <i>NLA</i>	Bolt (3/8-24 x 2 1/4 Carriage)			
50	1509-18 <i>NLA</i>	*Bolt (3/8-24 x 1 3/8 Hex Head)			

For Illustration see page 5

\*Standard Hardware Item—may be purchased locally

# Model 6032-2 Driveway Car

## CORVETTE

ALL UNNUMBERED  
PARTS INTERCHANGEABLE  
WITH OPPOSITE SIDE

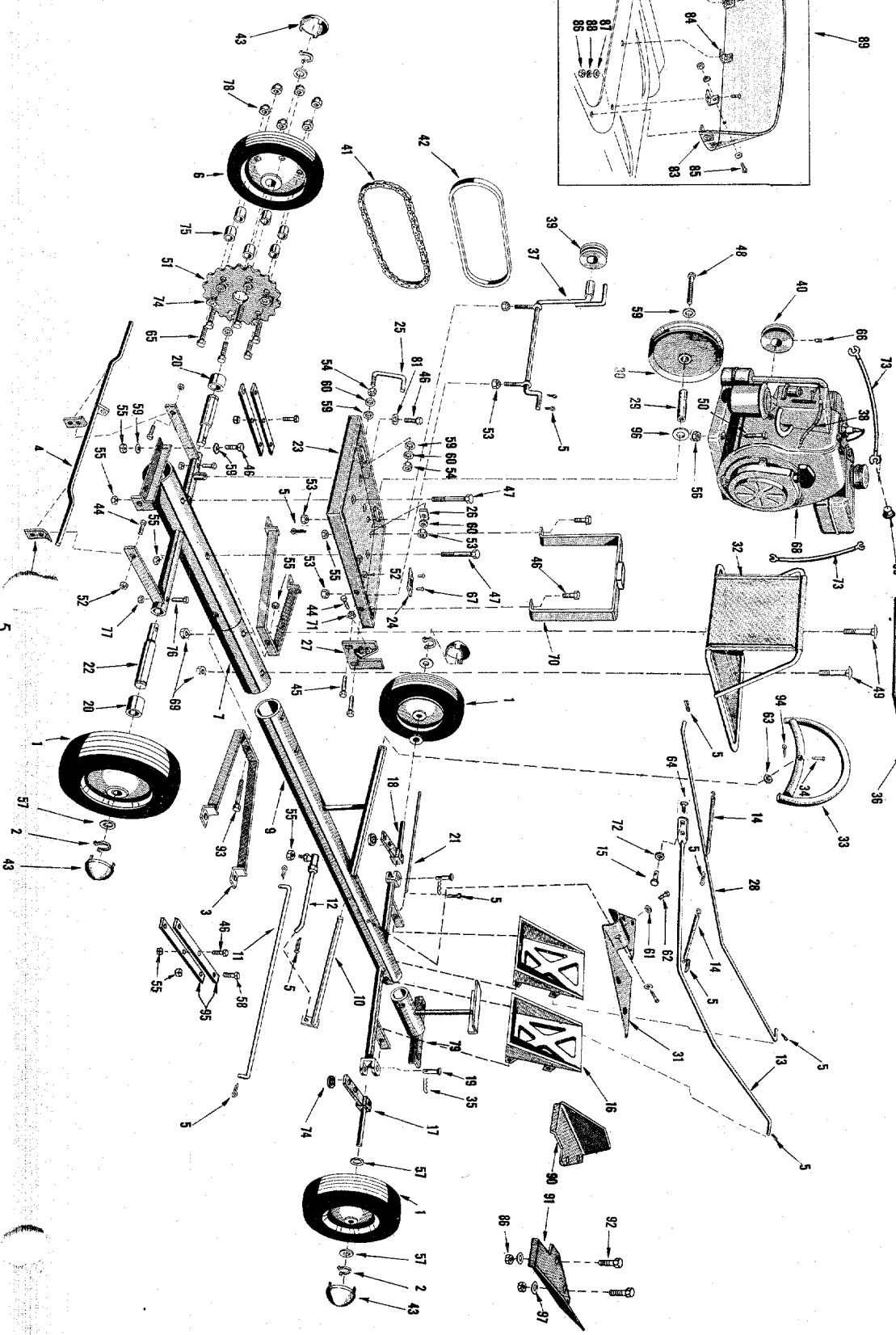
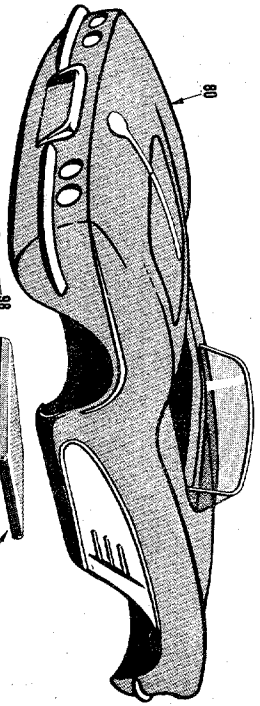
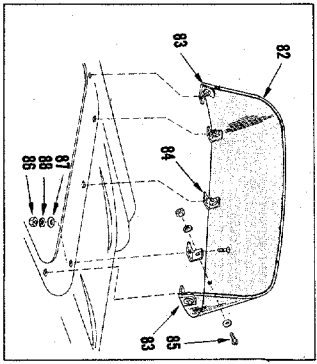

## V-BELT ADJUSTMENT

1. Loosen idler bracket adjusting nut "A" two (2) full turns.
2. While holding eyebolt in line with idler bracket tighten nuts "B" securely.
3. Over tension of idler belt will cause Corvette to "Creep" when engine is started.
4. Under tension of Idler Belt will cause the Idler bracket to go over center and lock the accelerator pedal in drive position.
5. It is possible that operator may have to repeat procedure one (1) and two (2) until proper adjustment is obtained.
6. Lower belt guide must fit snugly against idler belt.
7. When idler shaft adjustment is complete eye-bolts must be positioned so that idler shaft is always free to rotate.

## TO CHANGE V-BELT

1. Loosen and slide jackshaft assembly to extreme rear position. Remove chain from jackshaft sprocket.
2. Remove worn belt. Start new belt onto engine pulley making sure belt is positioned beneath upper belt guide.
3. Replace chain and make necessary adjustments. If the chain has stretched, one (1) link must be removed and replaced with one (1) half link.

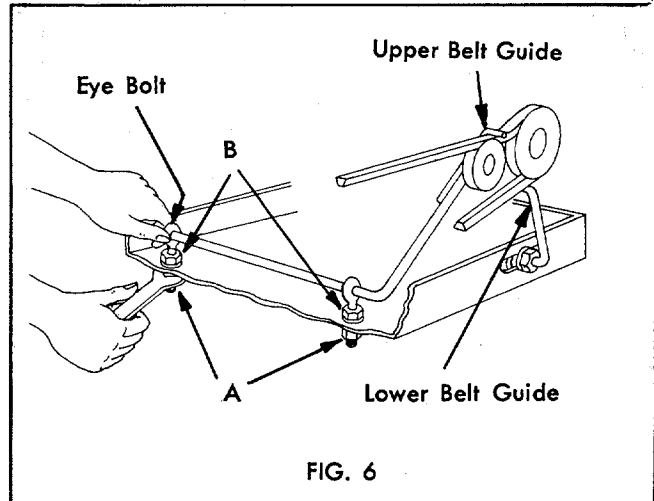

FIG. 6

## LUBRICATION

1. Change oil in crankcase after first five (5) hours of operation. Refer to engine manual for complete details.
2. Air cleaner protects engine from grit and dirt. Dry type air cleaner needs no oil. Refer to engine manual for complete details.
3. Oil all moving parts with engine oil after every five (5) hours of operation.
4. Wheel bearings should be lubricated with engine oil every 10 hours to assure longer service.

# WARRANTY

The Miniature Corvette is guaranteed for a period of 90 days from date of sale against defective material and workmanship, if the engine and jackshaft pulleys furnished with the Corvette have not been changed in size and the engine has not been altered or tampered with.

Abuse such as hitting other cars, striking curbs, etcetera will void the warranty.

Tires are not guaranteed against rolling off rims on turns or rapid wear due to speeding.

Engines sold for the Corvette will carry standard engine manufacturer's warranty. This warranty will be void if governed speed of 3600 RPM under load is increased.